

DOOR INSTALL GUIDE

VERSION 1

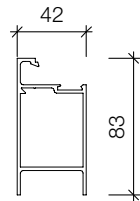
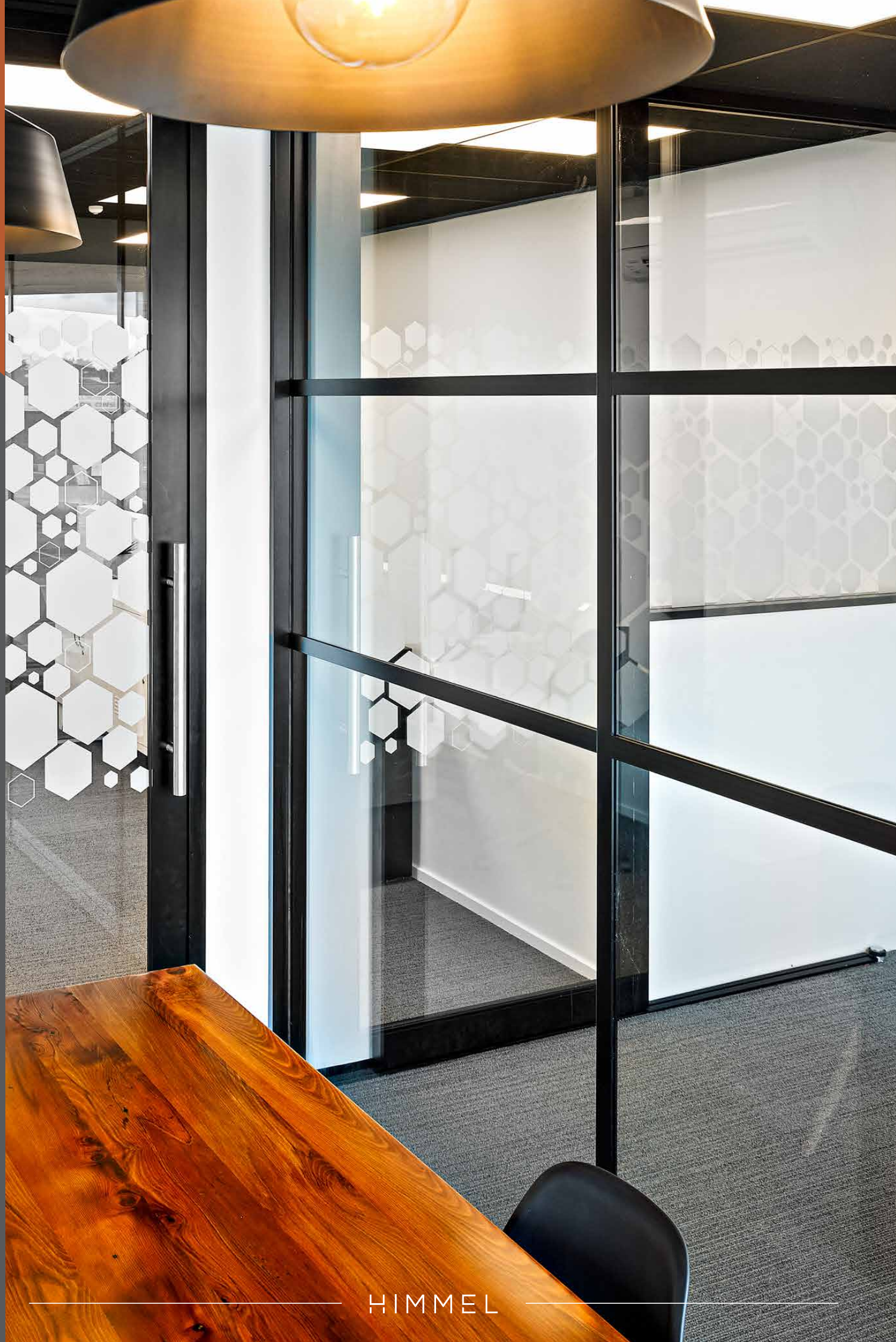

TOP RAIL - NARROW
DS45 83MM TOP RAIL

2.8M C/A: 182062
3.6M C/A: 182086
2.8M BLK: 182064
3.6M BLK: 182088

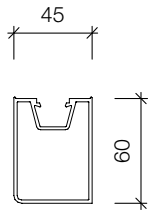

HINGE STILE - NARROW
DS45 60MM HINGE STILE

2.8M C/A: 182050
6.5M C/A: 182124
2.8M BLK: 182052
6.5M BLK: 182126

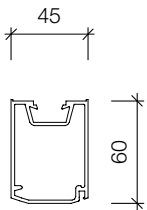

LOCK STILE - NARROW
DS45 60MM
LOCK STILE
(LH MORTISED) DS45 60MM
LOCK STILE
(RH MORTISED)

2.8M C/A: 182852 2.8M C/A: 182853
2.8M BLK: 182854 2.8M BLK: 182855

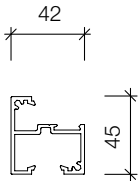

MID RAIL - NARROW
DS45 45MM MID-RAIL

6.5M C/A: 182110

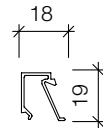

DOOR BEAD
DS45 DOOR RAIL BEAD

2.8M C/A: 181506
3.6M C/A: 181524
2.8M BLK: 181507
3.6M BLK: 181526

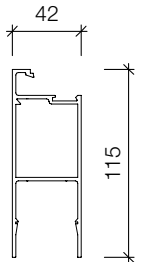

BOTTOM RAIL - WIDE
DS45 115MM BOTTOM RAIL

2.8M C/A: 182082
3.6M C/A: 182112
2.8M BLK: 182084
3.6M BLK: 182114

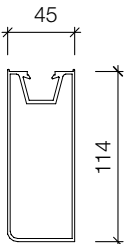

HINGE STILE - WIDE
DS45 114MM DOOR HINGE STILE

2.8M C/A: 182090
6.5M C/A: 182150
2.8M BLK: 182091
6.5M BLK: 182152

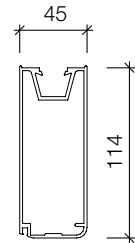

LOCK STILE - WIDE
DS45 114MM LOCK STILE

2.8M C/A: 182097
6.5M C/A: 182154
2.8M BLK: 182099
6.5M BLK: 182156

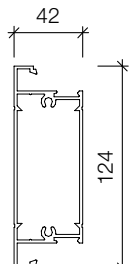

MID RAIL - WIDE
DS45 124MM MID-RAIL

6.5M C/A: 182869
6.5M BLK: 182871

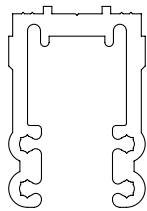

SPIGGOT
SPIGGOT (SET OF 4 WITH BOLTS)
178113



SPIGGOT SCREWS
BAG OF 100 - 155048
BOX OF 1000 - 183137

NARROW DOOR ASSEMBLY

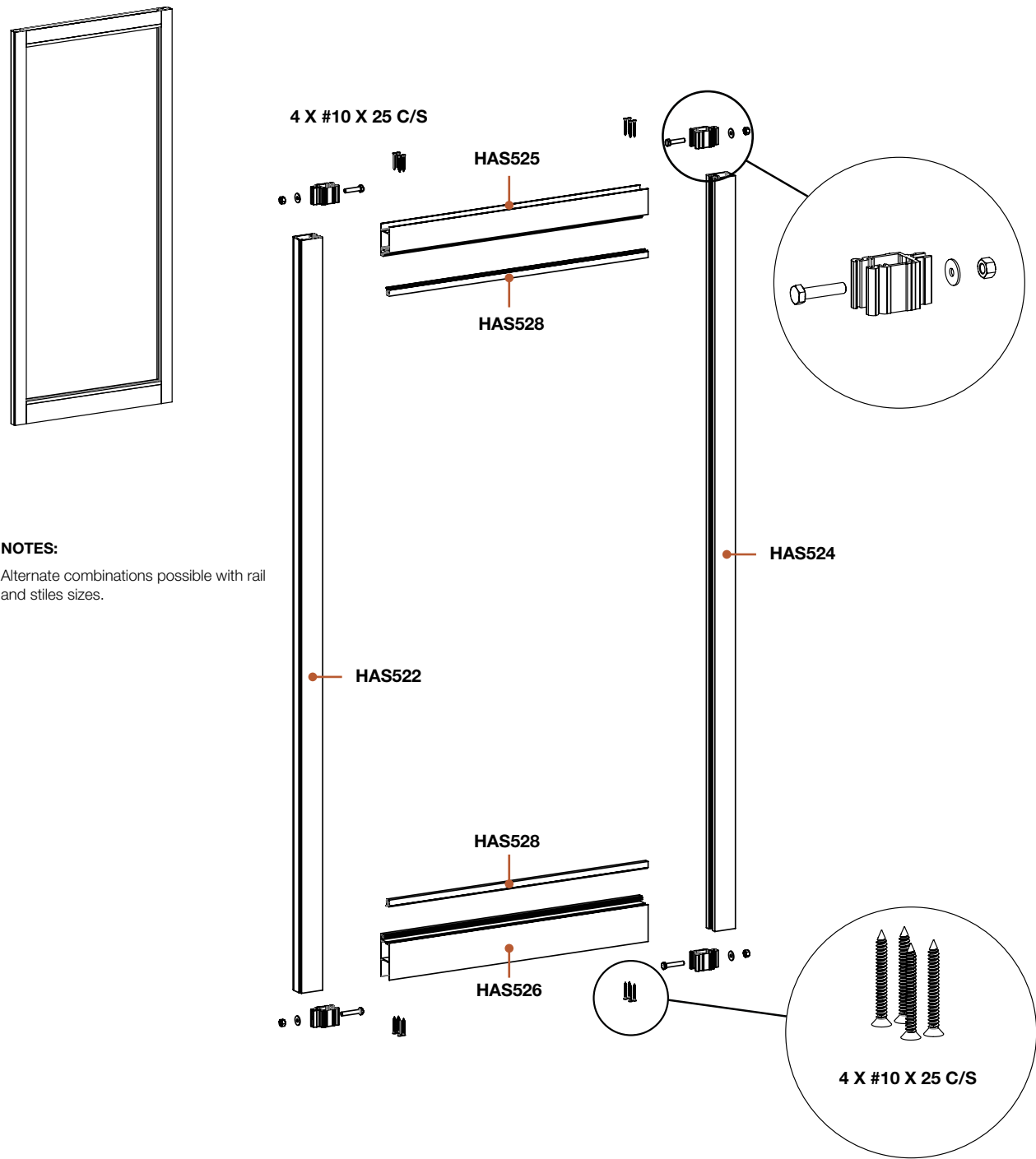

NOTES:
Alternate combinations possible with rail and stiles sizes.

NOTES:
Engineering, manufacture and installation must meet requirements of AS 2047-2048, AS/NZS 1170 and AS/ NZS 1664. Glazing selected must meet requirements of AS 1288. Size limitations are governed by design intent, glass selection, and local wind load requirements. An Engineer should be consulted to ensure selected framing and installation meets the requirements as set out by the relevant Australian Standards.

N.B.

- For frames, designs, and configurations outside the tested scope, an engineer should be consulted.
- All raw joints need to be sealed with small joint sealer or foam tab option.

WIDE DOOR ASSEMBLY

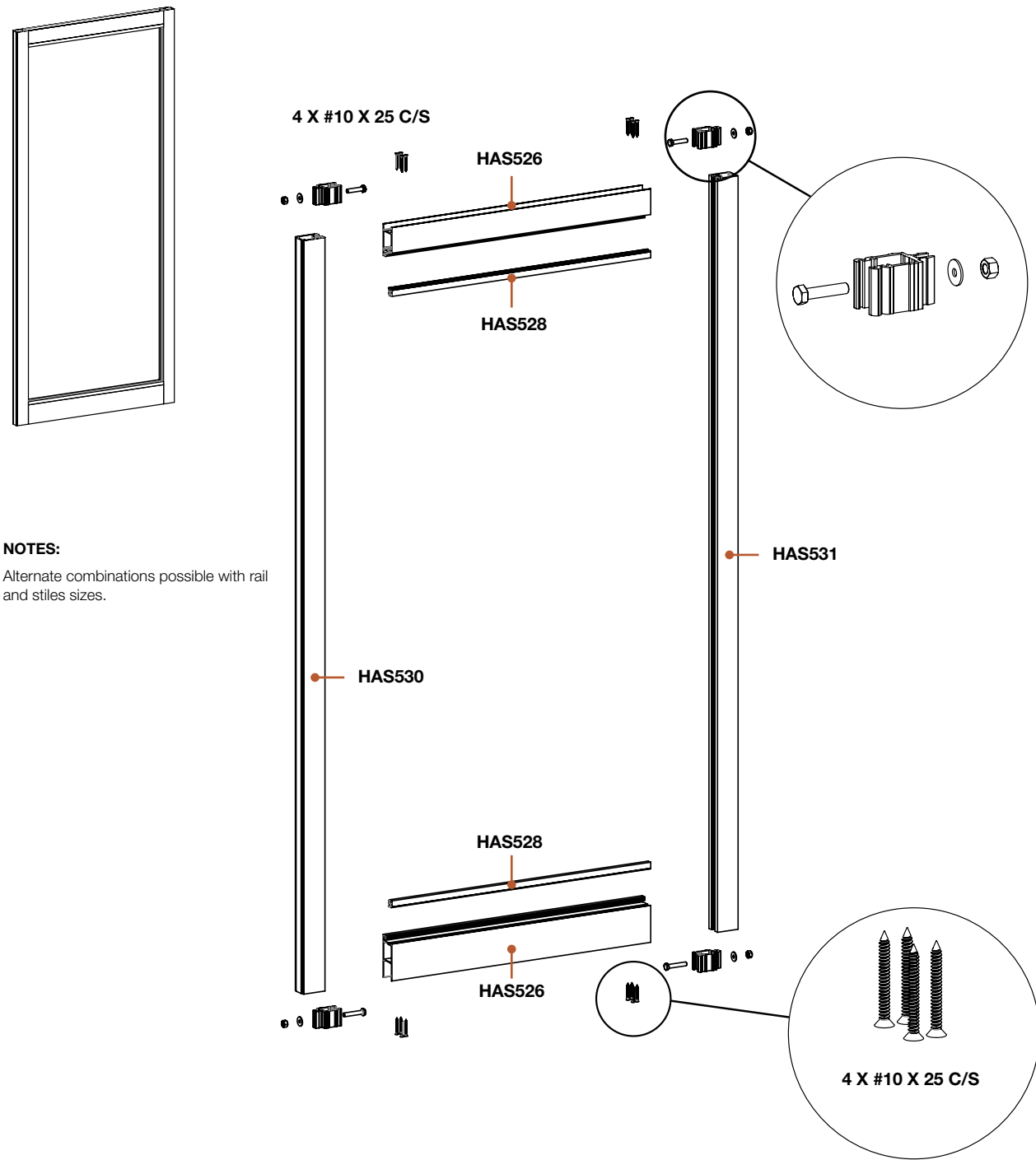

NOTES:
Alternate combinations possible with rail and stiles sizes.

NOTES:
Engineering, manufacture and installation must meet requirements of AS 2047-2048, AS/NZS 1170 and AS/ NZS 1664. Glazing selected must meet requirements of AS 1288. Size limitations are governed by design intent, glass selection, and local wind load requirements. An Engineer should be consulted to ensure selected framing and installation meets the requirements as set out by the relevant Australian Standards.

N.B.

- For frames, designs, and configurations outside the tested scope, an engineer should be consulted.
- All raw joints need to be sealed with small joint sealer or foam tab option.

Door Cross Section

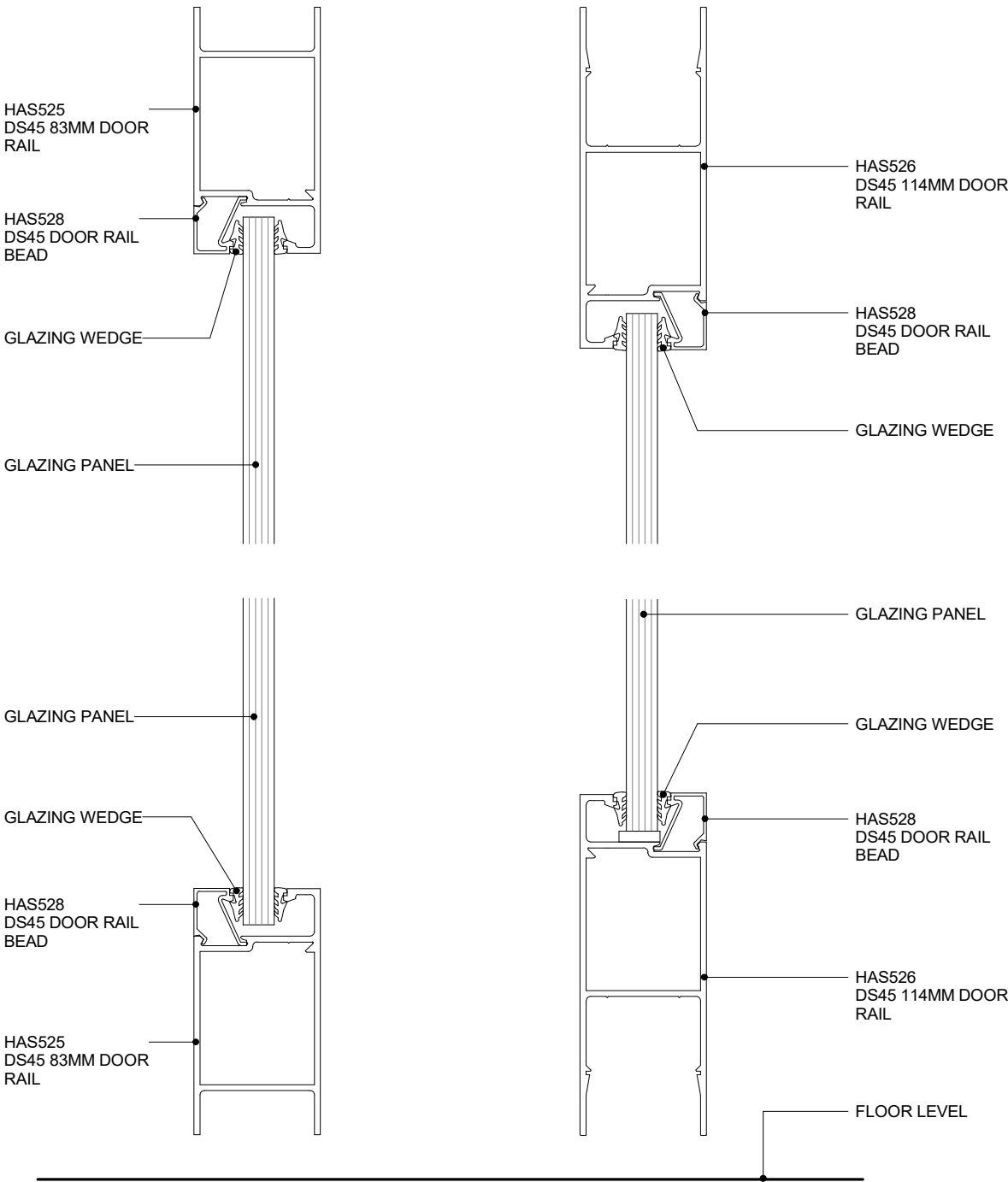

Style Types

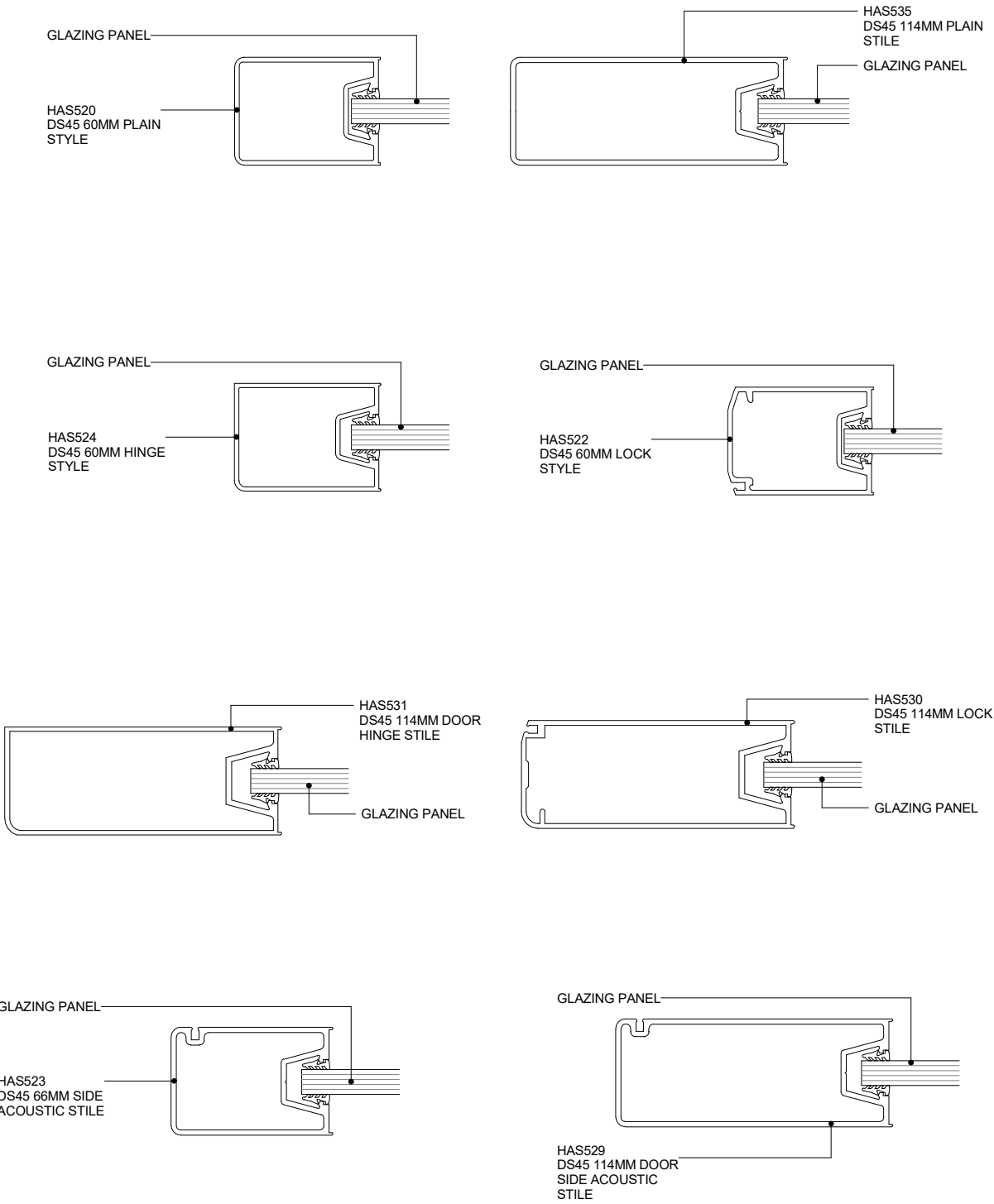

HIMMELTM

SAINT-GOBAIN

1300 374 253 | WWW.HIMMEL.COM.AU