

# Installation Guide

## FRICKER ALUMINIUM GRID SYSTEM

# Contents

<b>About Fricker ceiling systems</b>	<b>3</b>
Introduction	3
Key features	3
Technical features	3
<b>Ceiling grid systems and profiles</b>	<b>4</b>
Systems Overview	4
Profile Overview	5
<b>Flush face systems</b>	<b>6</b>
Flush face two way system	6
Flush face two way system components	6-7
<b>Mitred top hat and slimline systems</b>	<b>8</b>
Top hat two mitre exposed	8
Top hat two mitre system	8
Slimline two way system	9
Slimline two way system components	9
<b>Top hat one way system</b>	<b>10</b>
<b>Accessories</b>	<b>11</b>
<b>Installation method</b>	<b>12</b>
MR + MCR joining sequence	12
Bending tab	12
<b>Seismic accessory installation</b>	<b>13</b>
Fixed connection	13
Floating connection	13
<b>Contact us</b>	<b>14</b>

# About



Fricker Aluminium Grid Systems offer a customizable, lightweight and durable ceiling solution, ideal for installing acoustical panels in premium commercial buildings.

Trusted in landmark locations across Australia, Fricker is backed by Himmel, ensuring uncompromised quality and support from the initial specification through to long-term maintenance for the lifetime of the building.

The Fricker range includes modular options such as mitred top-hat, one-way and slimline systems, all designed to support concealed, semi-concealed and exposed tile-grid ceiling systems.

## Key Features

- Express installation and removal
- Reusable joining method
- Standard module sizes available (1200mm, 1350mm, 1500mm)
- Custom module sizes available
- Australian made, fast lead times

## Technical Features

- Produced from 6060-T5 extruded Aluminium
- Polyester powder coat finish (customizable)
- Compliant with AS/NZS 2785:2024 suspended ceiling design and installation and AS1170.4 when project specific design completed.



# Ceiling grid systems and profiles

## ■ Systems overview

### Fricker top hat aluminium

ORDER CODE	PRODUCT DESCRIPTION	SIZE	Each/carton
90729	Main runner - mitred	33 (face) x 50.7 (h) x 3600mm (l)	24
91307	Cross runner - mitred	33 (face) x 50.7 (h) x 1200mm (l)	24
90721	Main runner - mitred	33 (face) x 50.7 (h) x 4050mm (l)	24
91301	Cross runner - mitred	33 (face) x 50.7 (h) x 1350mm (l)	24
90741	Main runner - mitred	33 (face) x 50.7 (h) x 4500mm (l)	24
90522	Cross runner - mitred	33 (face) x 50.7 (h) x 1500mm (l)	24

### Fricker flush face aluminium

ORDER CODE	PRODUCT DESCRIPTION	SIZE	Each/carton
90107	Main runner	23 (face) x 43 (h) x 3600mm (l)	40
90340	Cross runner	23 (face) x 43 (h) x 1200mm (l)	40
90343	Cross runner	23 (face) x 43 (h) x 600mm (l)	40

### Fricker inverted u/slimline aluminium

ORDER CODE	PRODUCT DESCRIPTION	SIZE	Each/carton
90617	Main runner	14 (face) x 49 (h) x 3600mm (l)	40
90500	Cross runner	14 (face) x 49 (h) x 1200mm (l)	40
90501	Cross runner	14 (face) x 43 (h) x 600mm (l)	40

### Fricker inverted u/slimline aluminium - 1350 x 450mm

ORDER CODE	PRODUCT DESCRIPTION	SIZE	Each/carton
90616	Main runner	14 (face) x 49 (h) x 4050mm (l)	40
90499	Cross runner	1350 (l) x 49 (h) x 14mm (face)	40

### Fricker aluminium wall angle

ORDER CODE	PRODUCT DESCRIPTION	SIZE	Each/carton
93320	Wall angle shadowline	3660 x 10 x 10mm	30
89948	Wall angle 20mm	3250 x 25 x 20mm	10

### Fricker C splines

ORDER CODE	PRODUCT DESCRIPTION	SIZE	Each/carton
128241	C spline	1185 x 25 x 10mm	EA
133327	C spline	1333 x 11 x 23mm	EA
89953	C spline	1485 x 35 x 10mm	20

### Fricker clips and accessories

ORDER CODE	PRODUCT DESCRIPTION	Ea/carton	ORDER CODE	PRODUCT DESCRIPTION	Ea/carton
90614	Main runner joiner clip 39.5mm	100	89941	Bulkhead trim 3660 x 27 x 50mm white	EA
90283	Suspension clip	100			

## ■ Profiles overview

### Fricker top hat aluminium profile

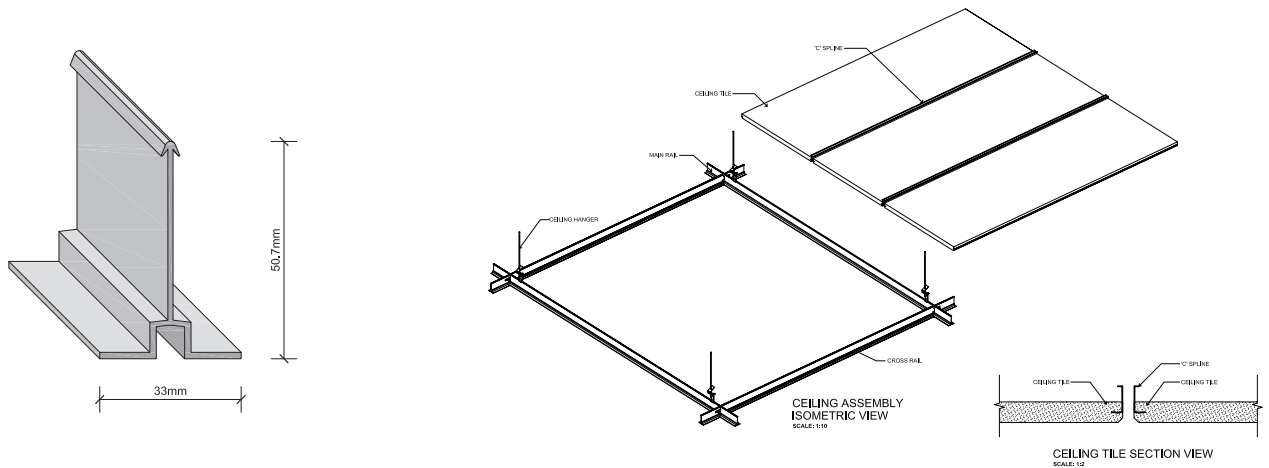

### Fricker flush face aluminium profile

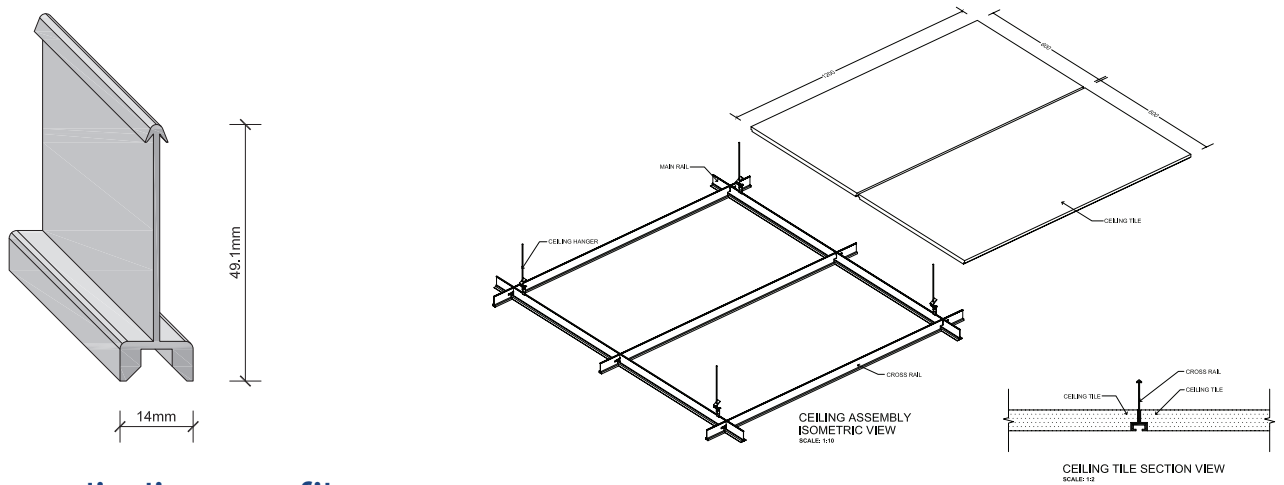

### Fricker slimline profile

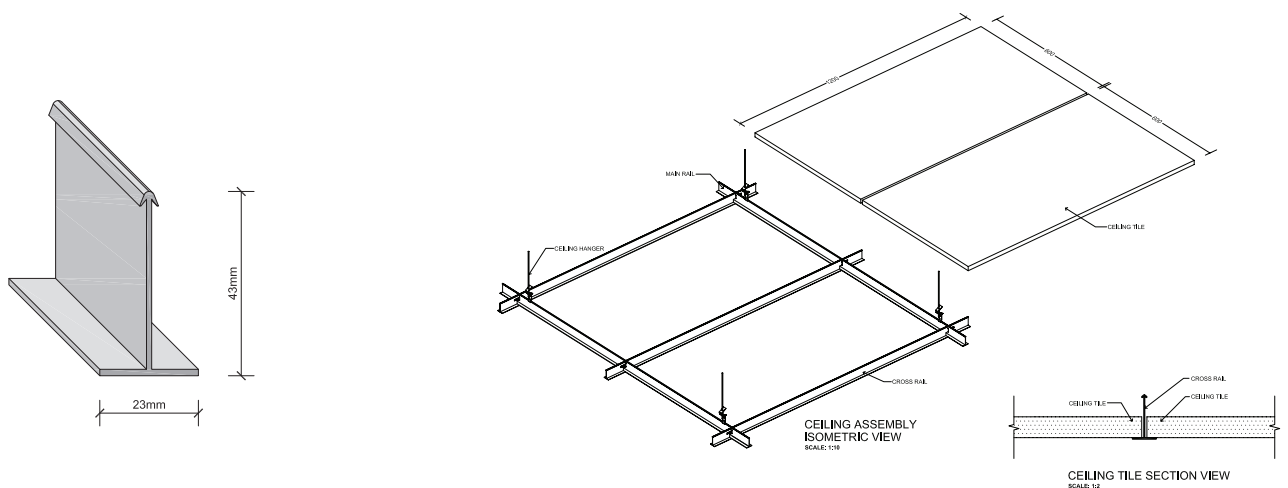

Accessory part numbers are available in the CSR Himmel Product Guide.

# Flush face systems

The Fricker flush face system can be used with exposed or concealed tile systems (such as Ecophon Ds-edge tiles) to suit a range of design applications. Main runner and cross runner lengths are available in three standard module sizes, in a white powder coated finish. Custom module sizes are achievable, along with custom powder coat finishes, on request.

For all Fricker modules and profiles, including the flush face, top hat and slimline systems, suspension clips are to be installed at 1200mm centres.

## ■ Flush face two way system



## ■ Flush face two way system components



## Seismic clip install - eg. floating

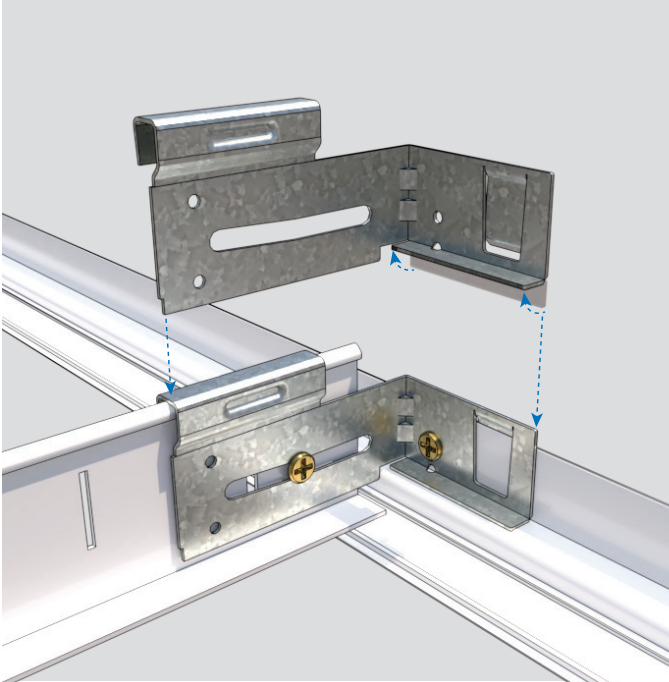

## End cap install

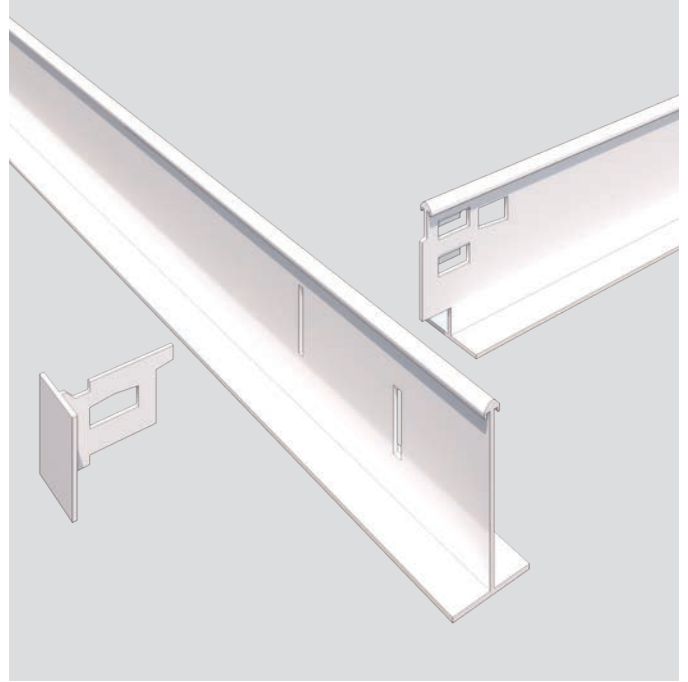

## Cross runner install

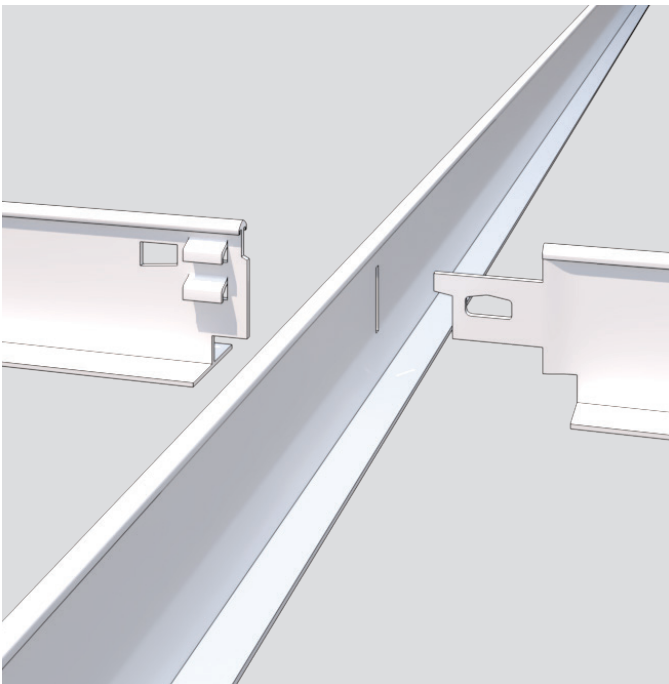

## Main runner joiner

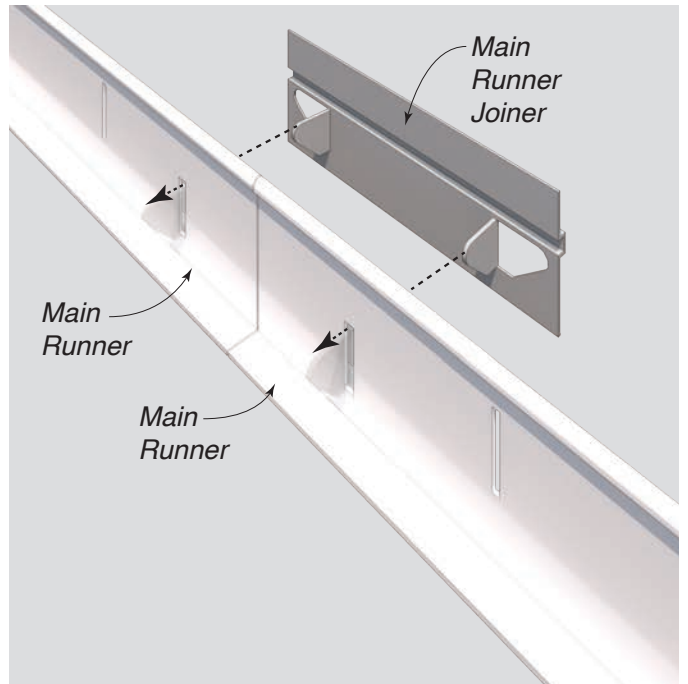

# Mitred top hat and slimline systems

Top hat and slimline profile grids are available in standard module sizes up to 1500mm x 1500mm.

Both profiles provide a continuous recess in both main runner and cross runner directions.

Exposed grid components are available in white powder coat finishes. Custom lengths and colourways are available on request.

## ■ Top hat two mitre exposed

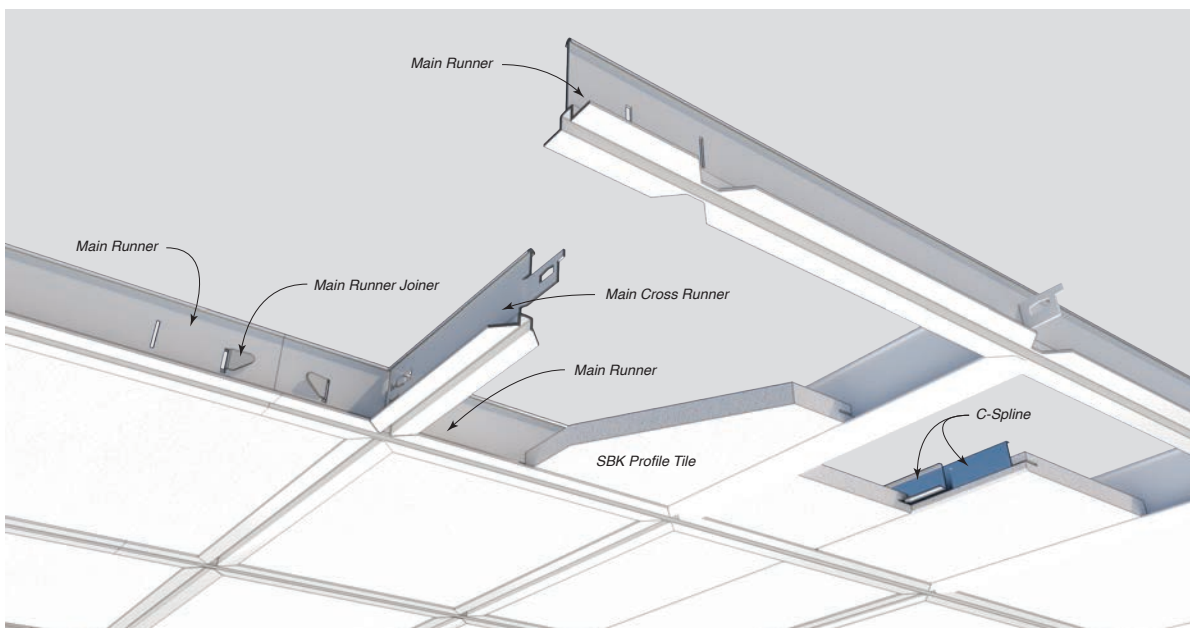

## ■ Top hat two mitre system

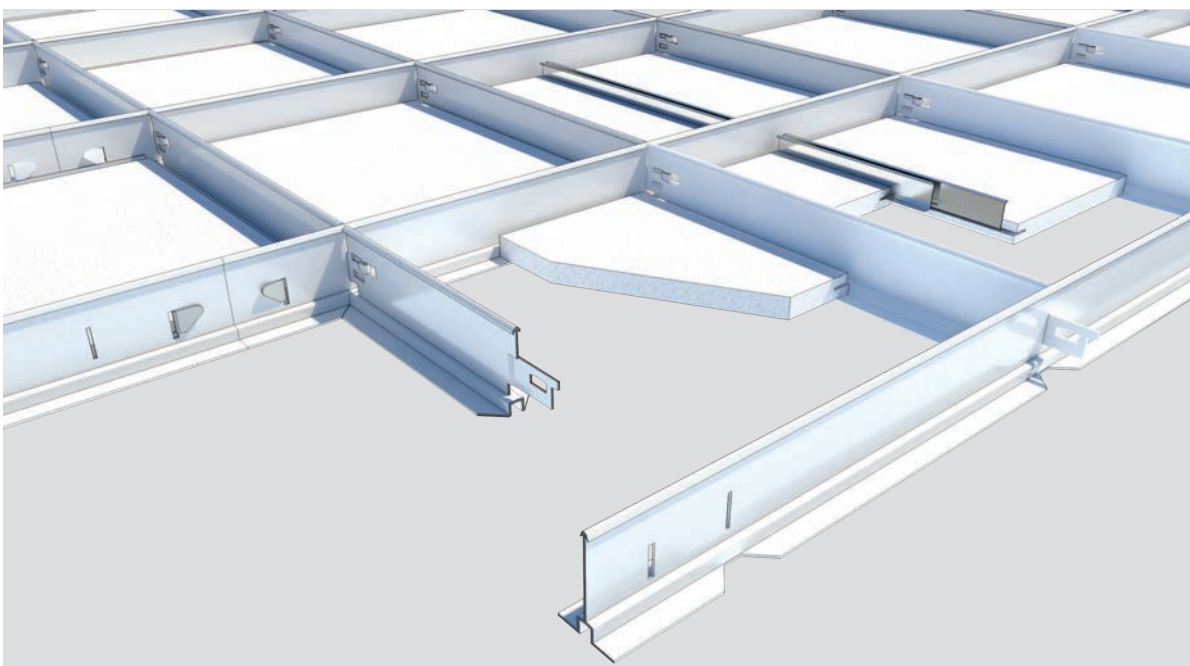



## ■ Slimline two way system

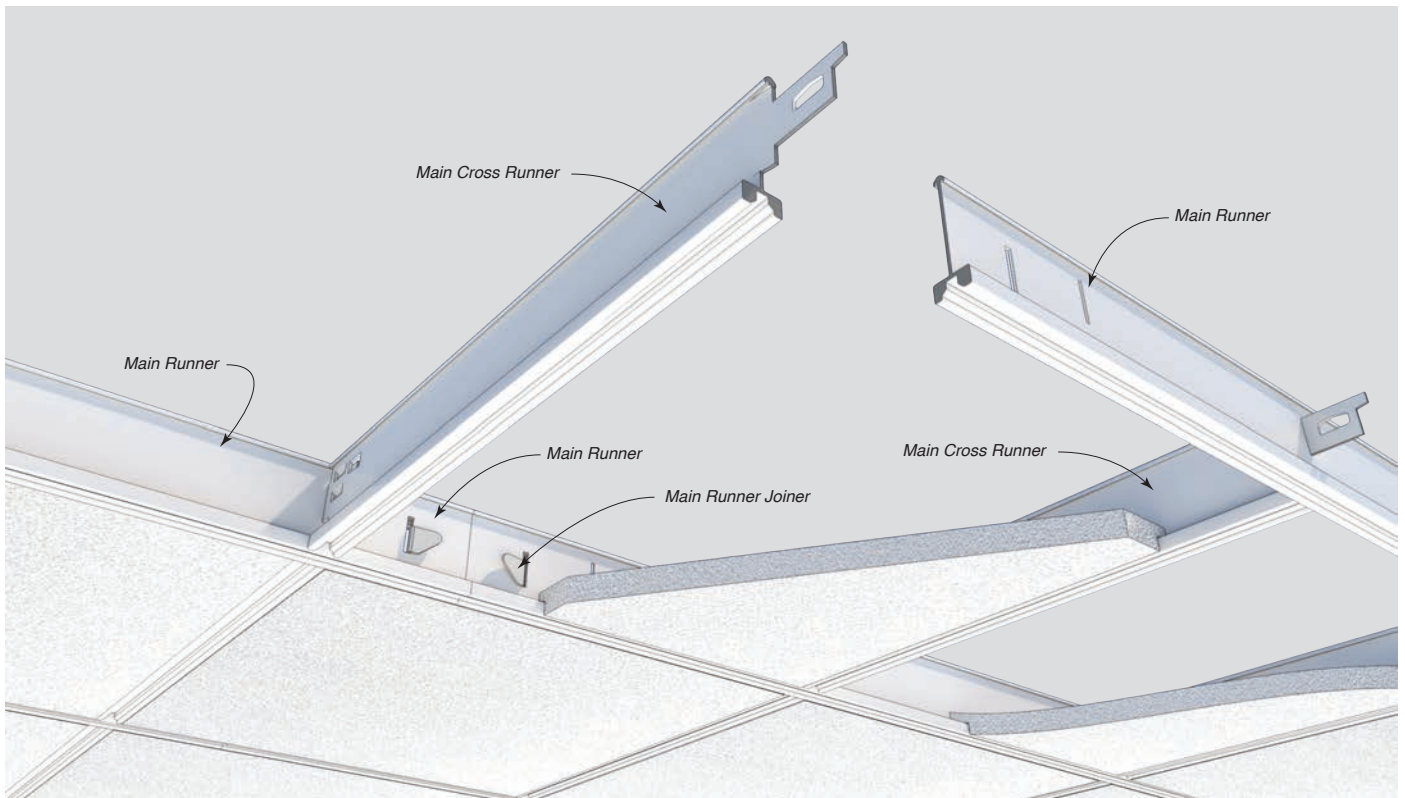

## ■ Slimline two way system components



# Top hat one way system

The one way system has been designed to expose only the top hat main runner. Locking blind struts function as the cross runner, and have been designed to secure SBK-edge tiles into the grid profile. To support the tile installation, back bracing struts are available to ensure main runner alignment.

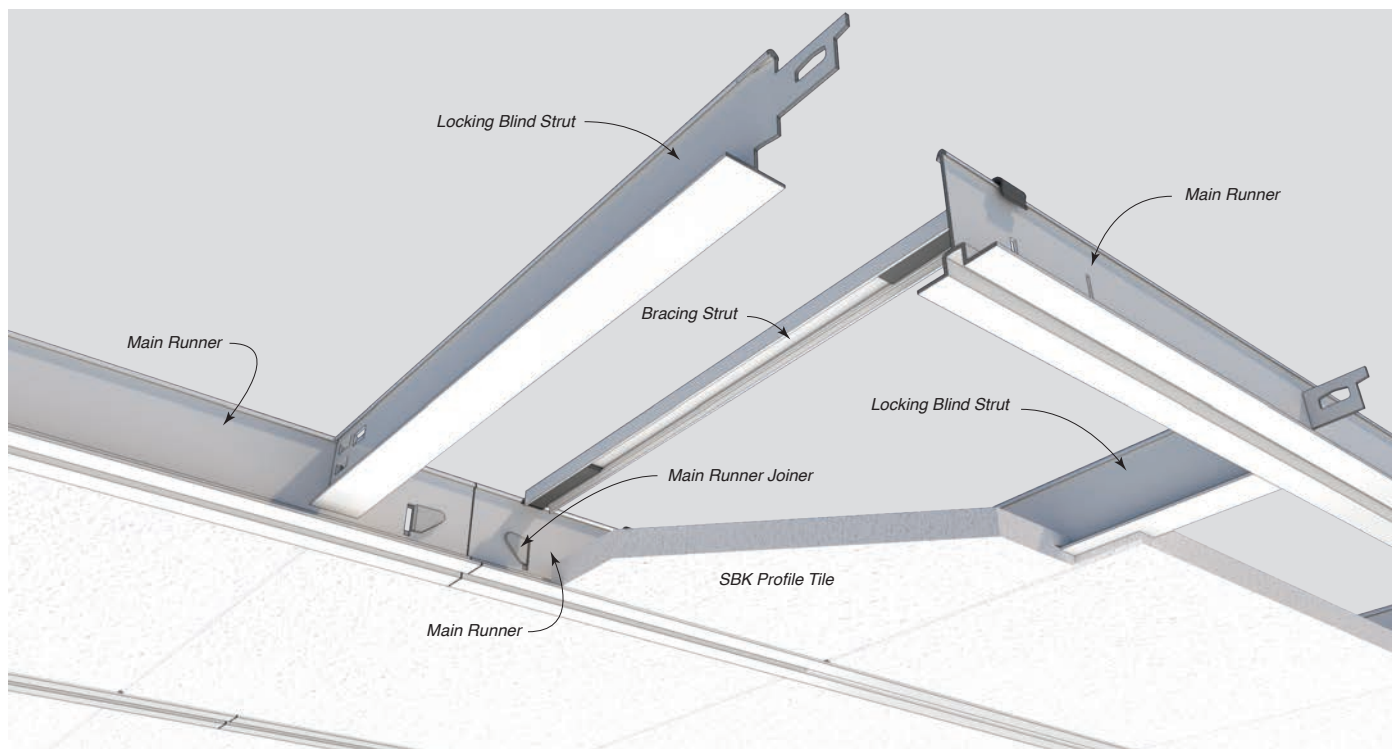

## ■ Top hat one way system

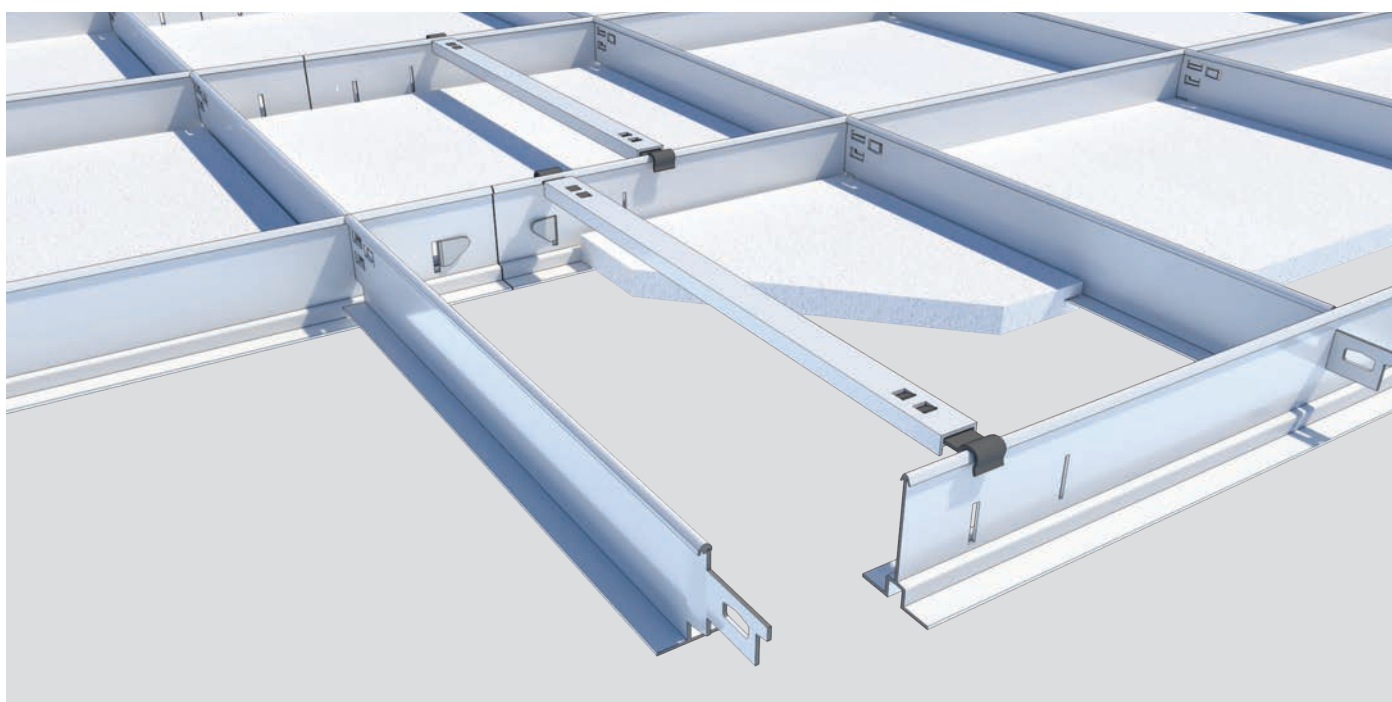

# Accessories

Fricker has a range of accessories available, which enables seamless integrations with bulkheads, upturns and pelmet installations.

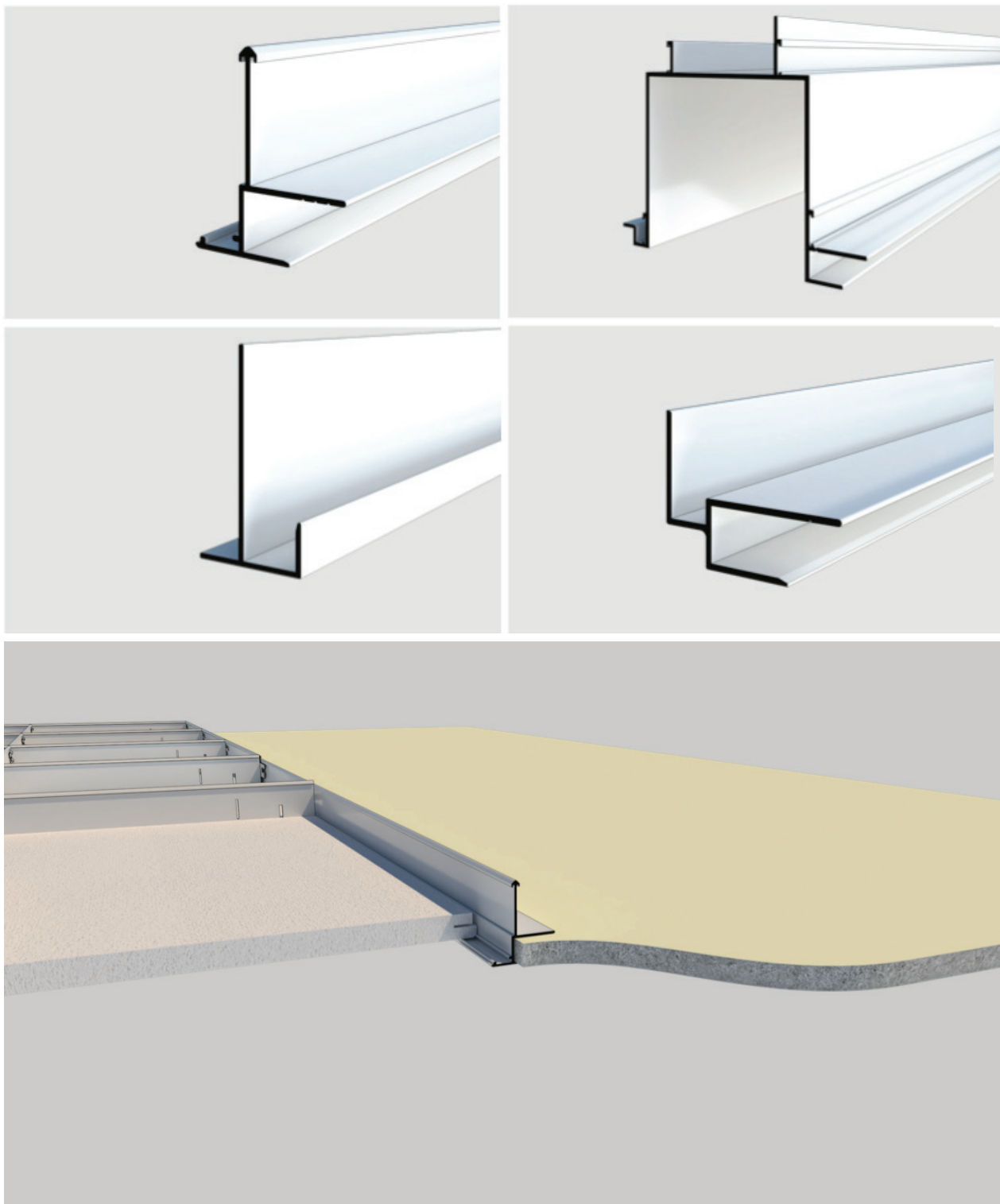

# Installation method

## ■ MR + MCR joining sequence

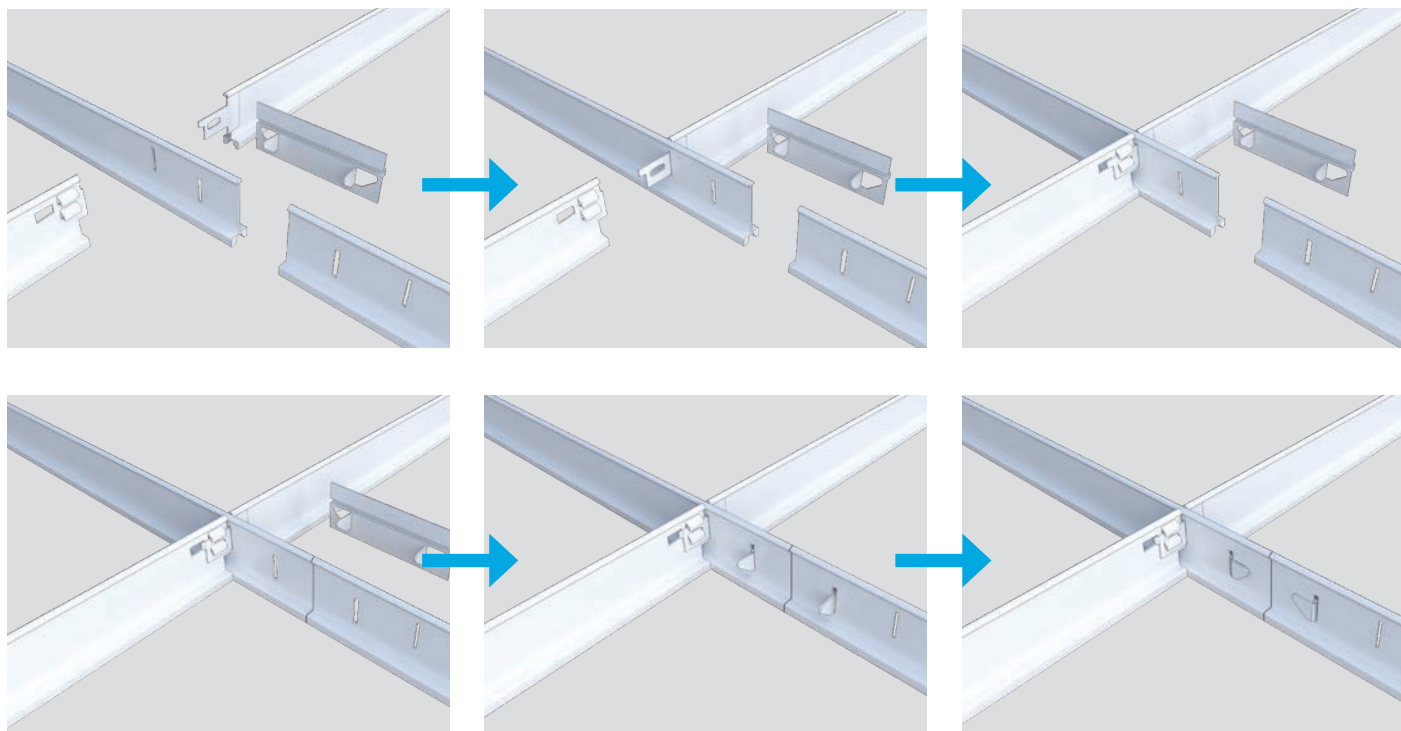

## ■ Bending tab

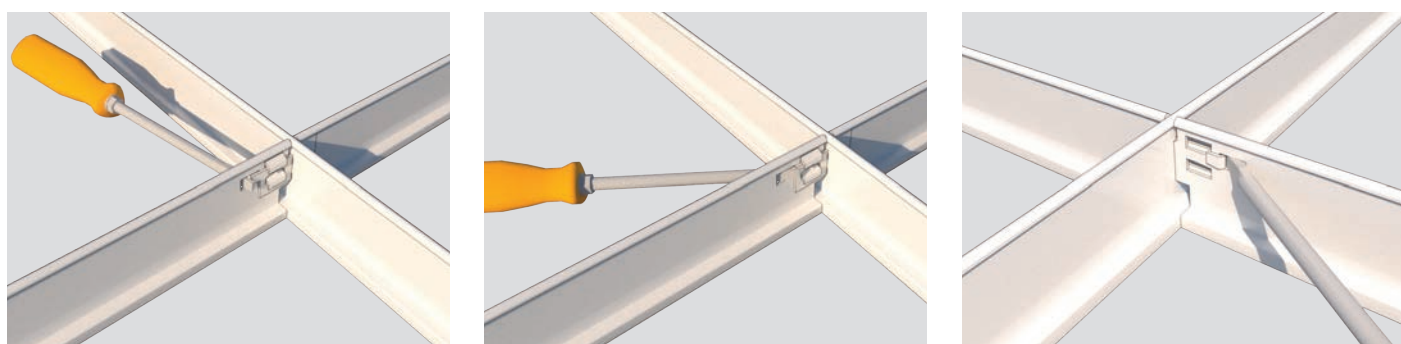

# Seismic accessory installation

When designed at a project level and installed in accordance with this manual (or the other seismic manual) the Fricker system is able to meet the regulatory requirements of AS/NZS2785 and AS1170.4, using Fricker seismic clips and the Tracklok bracing system. Seismic clips can be installed in a fixed or floating configuration depending on the seismic design requirements.

Hanger spacing is recommended at no more than 1200mm centres, with consideration

given to hanger spacing specified in the Fricker ceiling guide to account for seismic clips. We recommend the use of Tracklok GRD-10 to integrate with the top hat, slimline and flush face profiles. These can be installed using furring channels and secured to the ceiling using accessory clips BC90 or BC45.

To ensure Fricker modules comply with current standards, please refer to the Seismic Design Guide.



Scan me

## ■ Fixed connection

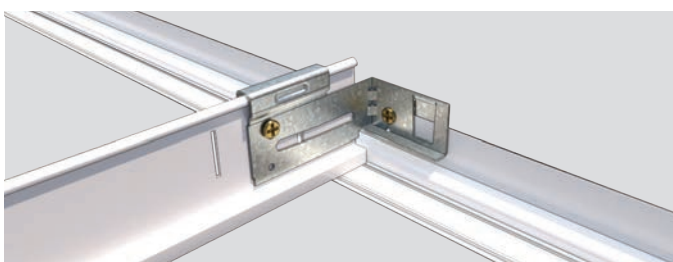

## ■ Floating connection

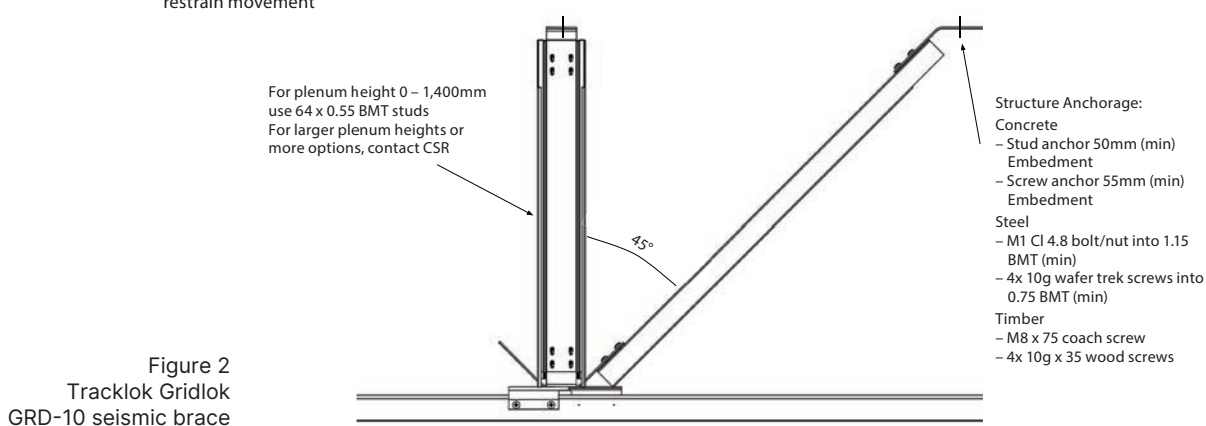
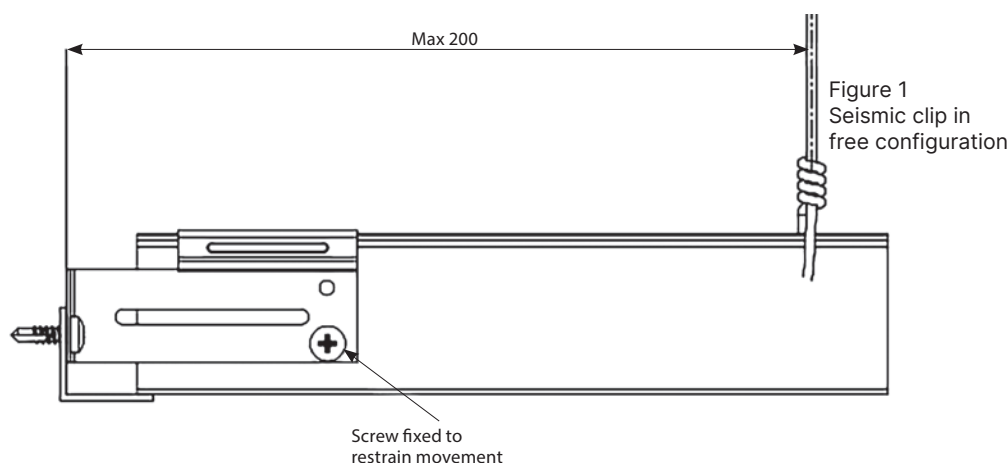
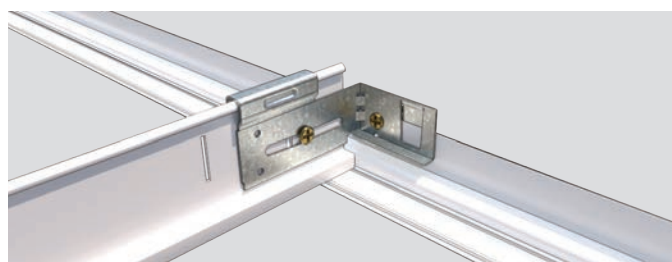

# HIMMEL™

## INTERIOR SYSTEMS

1300 374 253

[www.himmel.com.au](http://www.himmel.com.au)

The Himmel team can assist you with any project or enquiry.

Contact us on 1300 374 253 or email us at [HimmelCustomerService@csr.com.au](mailto:HimmelCustomerService@csr.com.au)

NSW  
26 Steel St,  
Blacktown  
NSW 2148  
1300 374 253

QLD  
Gate 3, Shed 20  
221 Hedley Ave,  
Hendra QLD 4011  
(07) 3212 6467

VIC  
131 Calarco Dr,  
Derrimut  
VIC 3030  
(03) 9217 8700

SA  
Lot 100 Sharp  
Court, Mawson  
Lakes SA 5095  
(08) 8344 0666

WA  
6 Ledger Rd,  
Balcatta  
WA 6021  
(08) 6241 6800

